

Pos. Nr. Pos.no.	Beschreibung Description	Art.-Nr. Art.no.	Preisgruppe Price bracket
73706 GYSEV BR 651			
73707			
1	Motor Motor	85091	28
2	Kardanschale kurz Cardan bearing short	87129	4
3	Platine komplett Printed citcuit assembly	87867	21
4	Puffer Buffer	106775	4
5	UIC-Steckdose UIC-Socket	114633	3
6	Gummibettung Rubber embedding	89728	4
7	Brückenstecker Connector	100644	6
8	Lichtleitstäbesatz Light transmission bar set	101236	7
9	Motorauflage Motor bearing	101238	4
10	Grundrahmen Base frame	107578	16
11	Tank Tank	134311	16
12	TS-Gehäuse lackiert Part set body coated	134679	12
13	Drahtlampe 16V Light bulb 16V	109321	8
14	TS-Dach Part set roof	112691	11
15	GF-Schraube M2x5 GF-screw M2x5	114966	3
16	Lichtabdeckungsfolie Light cover foil	115215	5
17	E-Lokführer Driver	116668	6
18	Inneneinrichtung Drivers cab	121183	6
19	Gehäuse kpl. Betr.Nr. 92 530 651 003-1 Body ass. Loco no. 92 530 651 003-1	134312	31
20	Fenstersatz Window set	107587	8
21	Laufblech Running board	121184	5
Sound			
22	Lautsprecher Loud speaker	129524	16
23	Sounddecoder 88mm Sounddecoder 88mm	129600	39
24	Schalkörper u. Halter Speakerframe a. holder	130289	6
25	Decoderhalterplatte Decoder holder plate	110614	6
26	Lautsprechergehäuse Loud speakerbox	110613	6
27	Doppelseitiges Klebeband Doublesided adhesive tape	112629	3

Änderungen in Konstruktion und Ausführung vorbehalten
We reserve the right to change the construction and specification

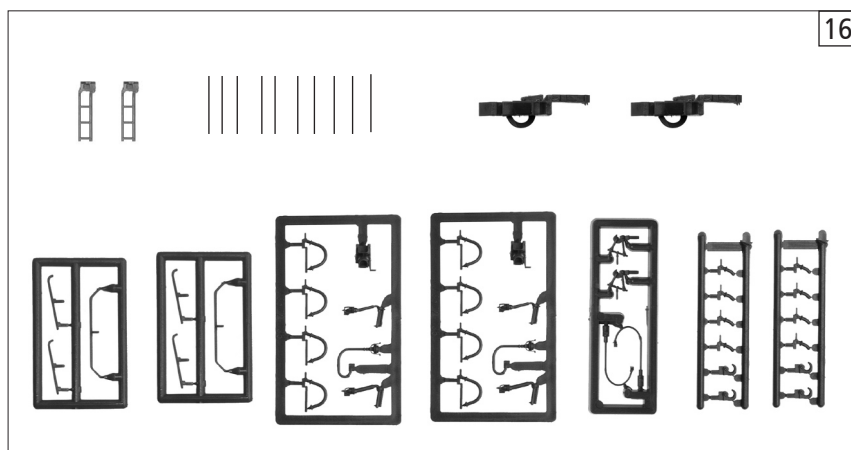
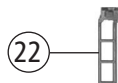
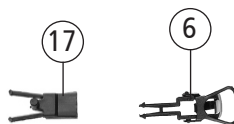
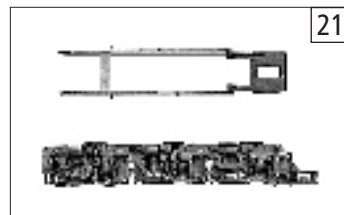
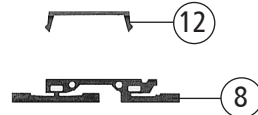
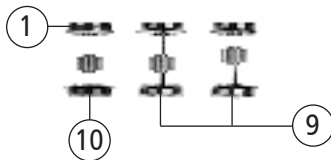
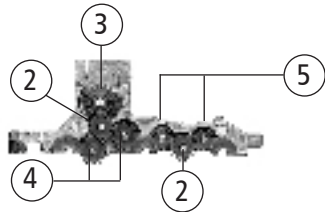
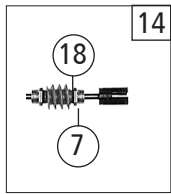
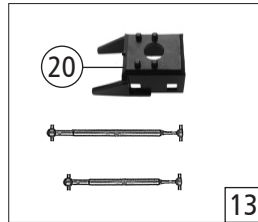
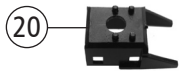

Pos. Nr. Pos.no.	Beschreibung Description	Art.-Nr. Art.no.	Preisgruppe Price bracket
73706	GYSEV BR 651		
73707			
1	Haftringsatz 10Stk. 12,5-13,48mm Set with traction tires 10 pieces	40066	--
2	Zahnrad Z=17/0,4G Gear Z=17/0,4G	86418	5
3	Schneckenrad Worm gear	86419	6
4	Zahnrad Z=18 Gear Z=18	86460	3
5	Zwischenrad Z=14 Gear Z=14	86480	3
6	Standardkupplung Standard coupling	89246	6
7	Lager für Schneckenachse Worm axle bearing	89749	6
8	Radkontakt Wheel current contact	89956	5
9	Radsatz m. Zahnrad o. Haftringen Wheelset w. gear without traction tires	107581	11
10	Radsatz m. Haftringen m. Zahnrad Wheelset with gear with traction tires	107582	12
11	Deckel DC Cover DC	121182	6
12	Kontakthalter Contact holder	107586	6
13	Teilesatz Part set	101240	8
14	Schneckensatz Worm set	101242	13
15	Getriebebesatz Part set gear	101244	11
16	Zurüstbeutel Bag with accessories	107583	17
17	Kupplungskammer Coupling holder	111944	4
18	Anlaufscheibe Washer disk	114622	3
19	GF-Schraube M1,6x6 GF-screw M1,6x6	114836	3
20	Schneckendeckel Worm cover	121285	4
21	TS - Blende-Getriebeabd. Partset bogie-gear cover	134313	11
22	Leiter Ladder	107589	4

Ersatzteile erhalten Sie direkt unter www.roco.cc, bei Ihrem Fachhändler oder Ihrer Landesvertretung:
Spare parts can be ordered directly at www.roco.cc and from your local dealer or country representative.